

# Meeting Room Diagram and Capacity Chart

## SECOND FLOOR LEVEL

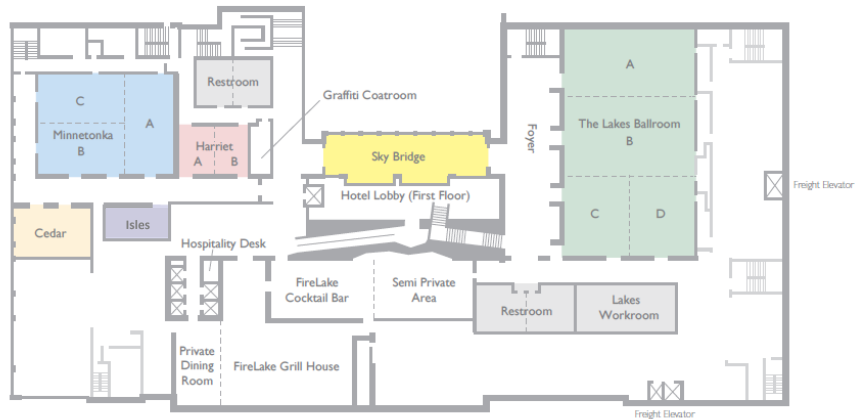

## THIRD FLOOR LEVEL



### MEETING ROOM CAPACITY

RADISSON BLU MALL OF AMERICA	Sq Ft	Dimensions	Ceiling Height	72" Rounds (10 per)	Theatre	Classroom 3 per 80"	Reception	Hollow Square	Conference	U Shape	Table Top Exhibits	Tradeshow Exhibits 8'x10'
The Lakes Ballroom	8,500	125 x 68	18 ft	700	1060	500	1062	-	-	-	101	63
Ballroom Foyer	2,500	125 x 20	18 ft	70	-	-	300	-	-	-	15	11
Salon A	2,652	39 x 68	18 ft	210	360	165	365	84	54	69	32	18
Salon B	2,924	43 x 68	18 ft	280	400	165	331	84	54	69	37	17
Salon C	1,462	43 x 34	18 ft	120	180	90	182	54	30	42	18	9
Salon D	1,462	43 x 34	18 ft	120	180	90	182	54	30	42	18	9
Salons A & B	5,576	82 x 68	18 ft	490	760	330	722	120	90	90	69	37
Salons C & D	2,924	43 x 68	18 ft	280	400	165	365	84	69	69	32	18
Salons B & C & D	5,848	86 x 68	18 ft	560	800	330	731	120	90	90	69	37
SkyBridge	2,225	89 x 25	8 ft	130	-	-	300	-	-	-	18	13
Minnetonka Ballroom	4,158	77 x 54	12 ft	340	500	250	512	102	60	72	50	26
Salon A	1,620	30 x 54	12 ft	140	200	99	202	66	42	54	22	10
Salon B	1,269	27 x 47	12 ft	100	150	72	152	54	36	45	16	7
Salon C	1,269	27 x 47	12 ft	100	150	72	152	54	36	45	17	7
Salons B & C	2,444	52 x 47	12 ft	200	300	168	351	78	42	65	32	18
Minnetonka BC Foyer	648	54 x 12	12 ft	-	-	-	130	-	-	-	10	-
Minnetonka AB	1,068	89 x 12	12 ft	-	-	-	75	-	-	-	5	-
Harriet Room	1,064	38 x 28	12 ft	60	120	63	80	36	24	30	13	7
Harriet A	532	19 x 28	12 ft	30	60	27	40	18	15	15	6	3
Harriet B	532	19 x 28	12 ft	30	60	27	40	18	15	15	6	3
Harriet Foyer	552	46 x 12	12 ft	-	-	-	50	-	-	-	5	-
Isles Boardroom	756	18 x 42	12 ft	-	-	-	-	-	20	-	-	-
Cedar Room	1,134	42 x 27	12 ft	80	130	72	149	48	30	39	14	7
Nokomis (3rd Floor)	1,768	26 x 68	12 ft	120	150	108	221	72	54	63	23	11
Nokomis A	598	26 x 23	12 ft	40	50	27	74	24	15	18	6	3
Nokomis B	572	26 x 22	12 ft	40	50	27	71	24	15	18	6	3
Nokomis C	598	26 x 23	12 ft	40	50	27	74	24	15	18	6	3
Nokomis A & B	1,170	26 x 45	12 ft	80	100	63	146	42	36	36	15	7
Nokomis B & C	1,170	26 x 45	12 ft	80	100	63	146	42	36	36	15	7
Nokomis Foyer	816	68 x 12	12 ft	-	-	-	100	-	-	-	5	5
Graffiti Coatroom	384	32 x 12	12 ft	-	-	-	-	-	-	-	-	-
Lakes Work Room	365	47 x 8	12 ft	-	-	-	-	-	-	-	-	-

\*Capacities Listed are the Maximum for Each Room. Please Allow for Reduced Seating Capacities Based on Additional Space Needs Such as AV and Staging\*