

# MEETING & EVENT SPACE

## Room Dimensions and Seating Capacity

Room Name	Square Feet	Ceiling Height	Dim.	Reception	Theater	Classroom	Ovals	U-Shaped	Hollow Square	Conference	Crescent
Galleria Ballroom	4,020	12'	60 x 67	500	400	250	320	60	102	-	260
Ballroom Lobby*	1,968	12'	24 x 82	240	-	-	-	-	-	-	-
Rembrandt*	1,980	12'	60 x 33	250	200	100	120	40	48	58	96
Picasso/DaVinci*	1,980	12'	60 x 33	250	200	100	120	40	48	58	96
Executive Room	360	10'	12 x 30	-	-	-	-	-	-	12	-
Renoir/Russell	900	10'	30 x 30	70	60	30	50	24	32	28	40
Van Gogh/Rem.	900	10'	30 x 30	70	60	30	50	24	32	28	40
Wyeth/Rockwell	900	10'	30 x 30	70	60	30	50	24	32	28	40
Liberty/Man.	1,088	10'	61 x 18	100	80	50	70	-	-	18	56
Manhattan	603	10'	33.5 x 18	50	40	32	30	-	-	18	24
Liberty	486	10'	27.5 x 18	30	30	20	30	-	-	16	24
New York	2,166	10'	30 x 72	200	150	56	120	-	-	-	64
New York 1*	900	10'	30 x 30	60	40	32	50	-	-	24	40
New York 2*	1,260	10'	30 x 42	75	60	40	70	30	24	25	64
Hudson	506	10'	22 x 23	40	40	20	30	20	16	18	24
Empire	369	10'	20.5 x 81	-	20	12	20	-	-	12	16

Presidential Suite: 959 square feet

Available for private events.  
Terrace Restaurant seats 134  
Off Broadway Lounge seats 95-100

Event Storage Rooms Available  
240 square feet,  
12 x 20 9-foot ceiling

VENDOR TABLES:  
Rent for \$20 per table

Vendors in Foyer - 13  
Vendors in N. Hall - 12  
Vendors in W. Hall - 9  
Freight Elevator 9' x 5'  
(holds 3200 lbs.)

Copies - \$.10 per copy  
Color Copies - \$.25 per copy

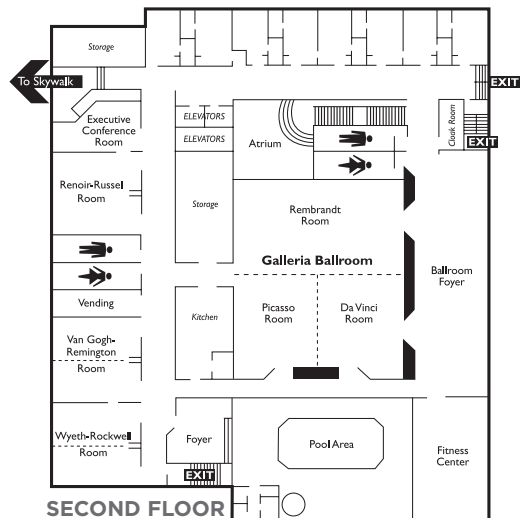
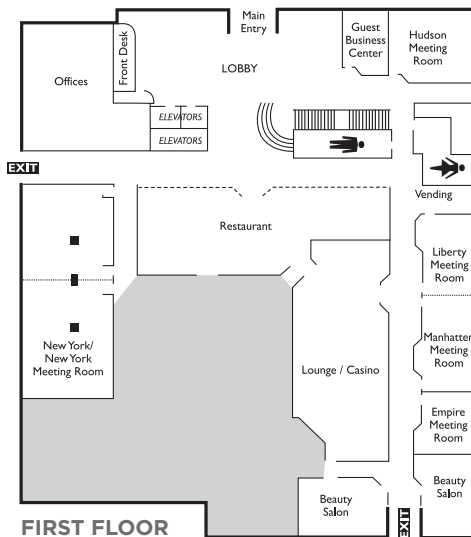

**Radisson Hotel Bismarck**  
6th & Broadway  
Bismarck, ND 58501

+1 (701) 255-6000  
radisson.com/bismarcknd\_downtown

