

Room dimensions and seating capacity									
Room	Sq. Ft.	Dim.	Theatre	Classroom	U-Shaped	Rounds	1/2 Rounds	Hollow Square	Reception
Hotel Ballroom	3,456	72x48	375	200	70	300	180	80	500
Ballroom A	1,728	36x48	180	100	40	150	90	50	250
Ballroom B	1,728	36x48	180	100	40	150	90	50	250
Hotel Foyer	2,013	n/a	n/a	n/a	n/a	90	n/a	n/a	250
Lobby Conference Room	225	15x15	n/a	n/a	n/a	n/a	n/a	n/a	n/a
WI Room	2,250	75x30	160	100	n/a	150	90	n/a	225
WI Room I	810	27x30	70	40	26	50	30	32	75
WI Room II	720	24x30	75	30	26	50	30	32	75
WI Room III	720	24x30	75	30	26	50	30	32	75
Combo WI Room I & II	1,530	51x30	120	75	n/a	100	60	n/a	150
Combo WI Room II & III	1,440	48x30	100	70	n/a	100	60	n/a	150
Minnesota Room	960	48x20	100	40	30	80	48	40	100
Minnesota A	480	24x20	50	20	15	40	24	20	50
Minnesota B	480	24x20	50	20	15	40	24	20	50
Iowa	648	27x24	75	30	26	50	30	32	75
Illinois	648	27x24	75	30	26	50	30	32	75

FIRST FLOOR

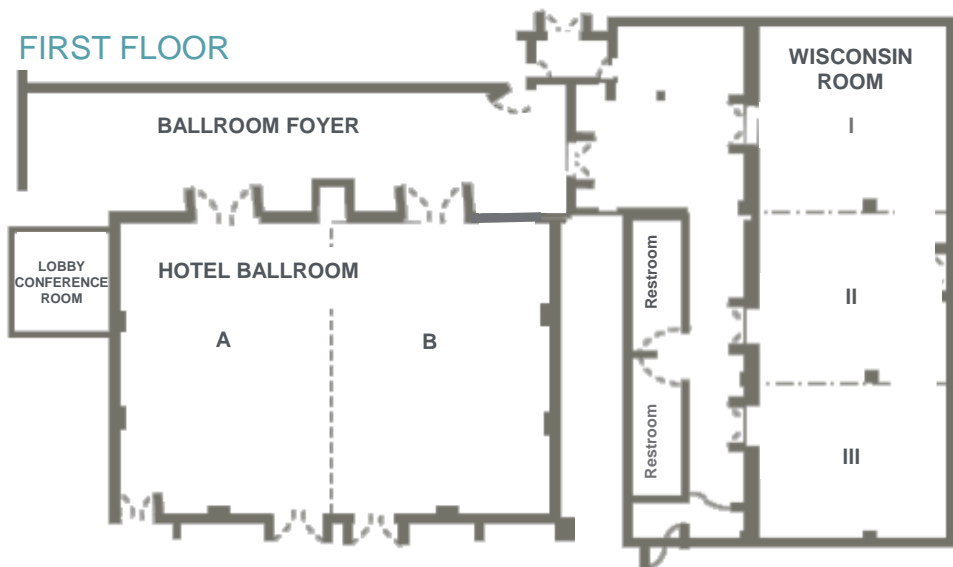

SECOND FLOOR

